

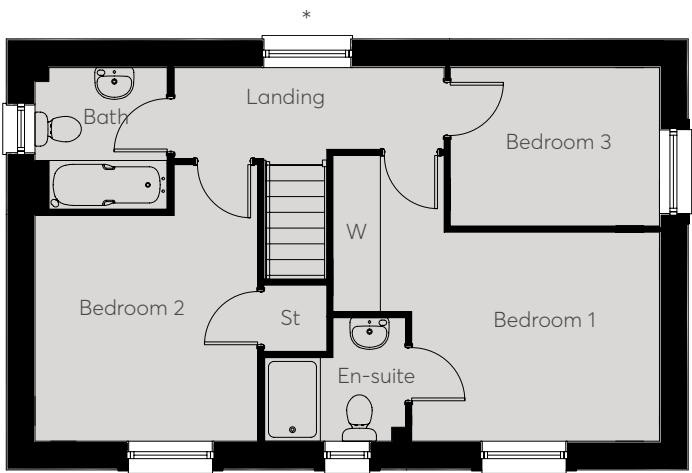

BROUGHTON

A THREE BEDROOM DETACHED
AND SEMI-DETACHED HOME

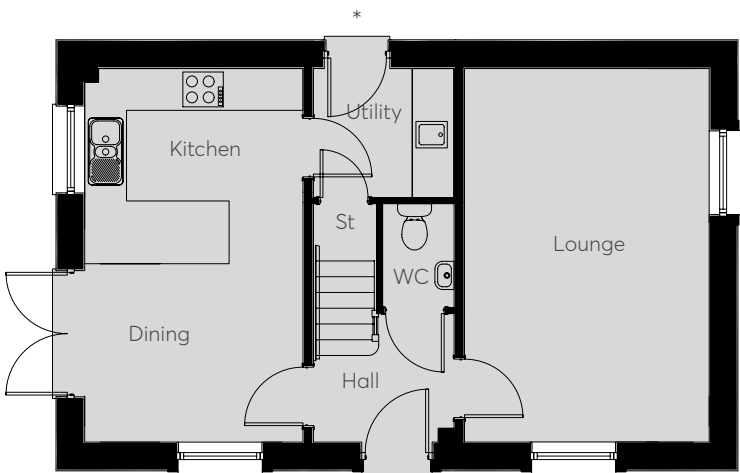

Please note: Plot 6 variation is a semi-detached property and has no door to ground floor utility room and no window to first floor landing, as indicated by ""

GROUND FLOOR

Kitchen	3.13m x 2.80m	10'3" x 9'2"
Dining	3.13m x 2.56m	10'3" x 8'5"
Lounge	5.36m x 3.51m	17'7" x 11'6"

FIRST FLOOR

Bedroom 1	4.63m x 3.00m	15'2" x 10'1"
Bedroom 2	3.24m x 3.19m	10'8" x 10'6"
Bedroom 3	3.00m x 2.27m	9'10" x 7'6"